

Figure 236. Pintle Hook Assembly.

ITEM NO	SMR CODE	CAGEC	PART NUMBER	DESCRIPTION AND USABLE ON CODES(UOC)	QTY
GROUP 1503 PINTLES AND TOWING ATTACHMENTS					
FIG. 236 PINTLE HOOK ASSEMBLY					
1	PAOOO	19207	8710630	PINTLE ASSEMBLY, TOW UOC: 614, 620, 622, 623, 624, 625, 626, 627, 628, 629, 630, 631, 632, 633, 634, 635, 636, 637, 638	1
2	PAOZZ	96906	MS24665-359	. PIN, COTTER UOC: 614, 620, 622, 623, 624, 625, 626, 627, 628, 629, 630, 631, 632, 633, 634, 635, 636, 637, 638	1
3	PAOZZ	96906	MS35692-1624	. NUT, PLAIN, SLOTTED, H UOC: 614, 620, 622, 623, 624, 625, 626, 627, 628, 629, 630, 631, 632, 633, 634, 635, 636, 637, 638	1
4	PAOZZ	19207	7714880	. LATCH, PINTLE HOOK UOC: 614, 620, 622, 623, 624, 625, 626, 627, 628, 629, 630, 631, 632, 633, 634, 635, 636, 637, 638	1
5	PAOZZ	19207	7044253	. SPRING, HELICAL, COMP UOC: 614, 620, 622, 623, 624, 625, 626, 627, 628, 629, 630, 631, 632, 633, 634, 635, 636, 637, 638	1
6	PAOZZ	19207	8710627	. LATCH, PINTLE HOOK UOC: 614, 620, 622, 623, 624, 625, 626, 627, 628, 629, 630, 631, 632, 633, 634, 635, 636, 637, 638	1
7	PAOZZ	19207	8710629	. SHAFT, STRAIGHT UOC: 614, 620, 622, 623, 624, 625, 626, 627, 628, 629, 630, 631, 632, 633, 634, 635, 636, 637, 638	1
8	PAOZZ	96906	MS15001-1	. FITTING, LUBRICATION UOC: 614, 620, 622, 623, 624, 625, 626, 627, 628, 629, 630, 631, 632, 633, 634, 635, 636, 637, 638	2
9	PAOZZ	96906	MS24665-631	. PIN, COTTER UOC: 614, 620, 622, 623, 624, 625, 626, 627, 628, 629, 630, 631, 632, 633, 634, 635, 636, 637, 638	1
10	PAOZZ	19207	8710628	. BOLT, FLUID PASSAGE UOC: 614, 620, 622, 623, 624, 625, 626, 627, 628, 629, 630, 631, 632, 633, 634, 635, 636, 637, 638	1
11	PAOZZ	96906	MS21318-47	. SCREW, DRIVE UOC: 614, 620, 622, 623, 624, 625, 626, 627, 628, 629, 630, 631, 632, 633, 634, 635, 636, 637, 638	1
12	MOOZZ	18876	819906-6	. CHAIN, WELDLESS MAKE FROM CHAIN, P/ N 819906 UOC: 614, 620, 622, 623, 624, 625, 626, 627,	1

ITEM NO	SMR CODE	CAGEC	PART NUMBER	DESCRIPTION AND USABLE ON CODES(UOC)	QTY
13	PAOZZ	19207	8710626	628, 629, 630, 631, 632, 633, 634, 635, 636, 637, 638 .HOOK, PINTLE UOC: 614, 620, 622, 623, 624, 625, 626, 627, 628, 629, 630, 631, 632, 633, 634, 635, 636, 637, 638	1
14	PAOZZ	19207	7714911	.NUT, PLAIN, SLOTTED, H UOC: 614, 620, 622, 623, 624, 625, 626, 627, 628, 629, 630, 631, 632, 633, 634, 635, 636, 637, 638	1
15	PAOZZ	46717	L6451-101	.PIN, COTTER UOC: 614, 620, 622, 623, 624, 625, 626, 627, 628, 629, 630, 631, 632, 633, 634, 635, 636, 637, 638	1
16	PAOZZ	19207	7764909	WASHER, FLAT UOC: 614, 620, 622, 623, 624, 625, 626, 627, 628, 629, 630, 631, 632, 633, 634, 635, 636, 637, 638	1

END OF FIGURE



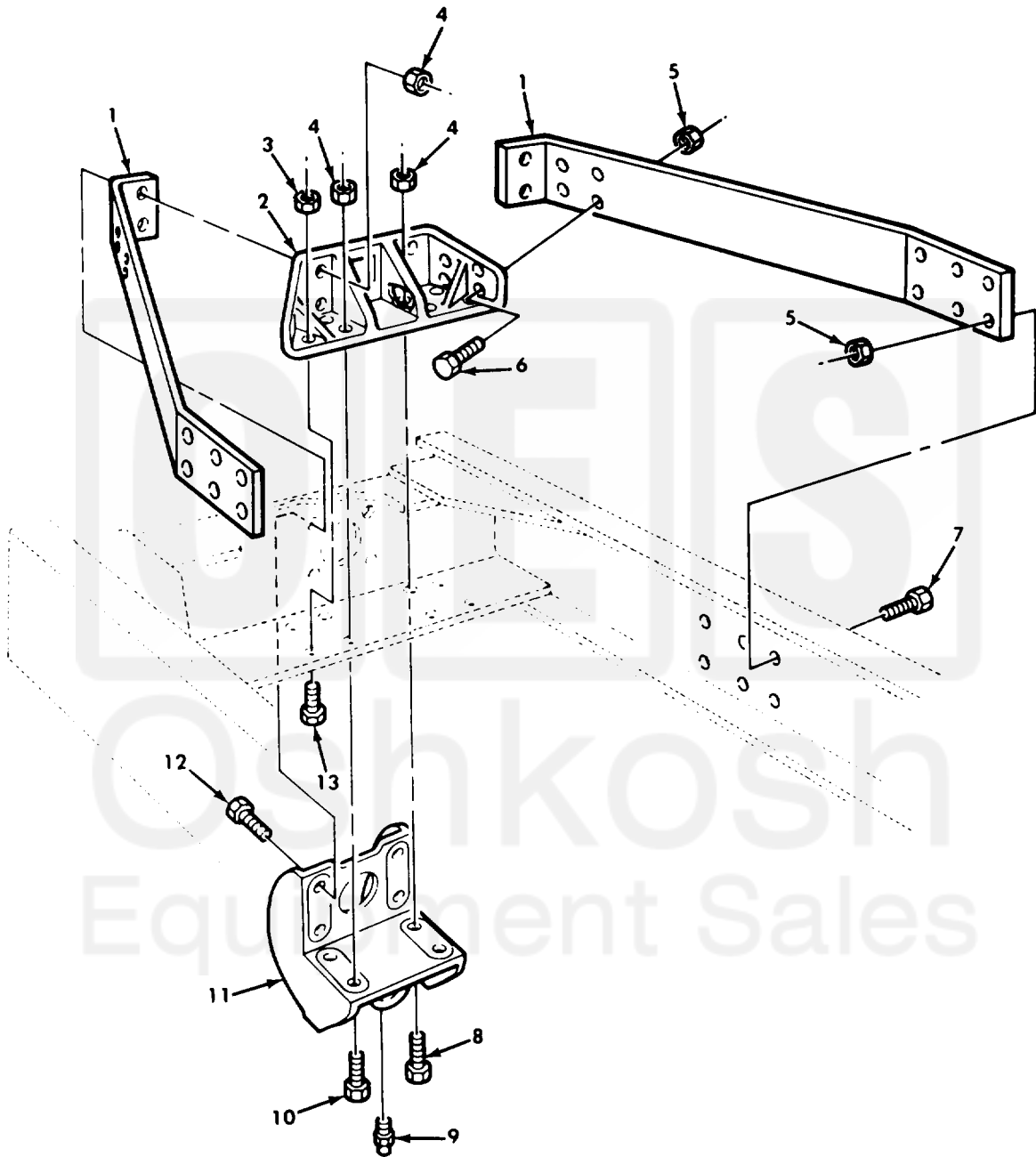

Figure 237. Towing Pintle Mounting Brackets.

ITEM NO	SMR CODE	CAGEC	PART NUMBER	DESCRIPTION AND USABLE ON CODES(UOC)	QTY
GROUP 1503 PINTILES AND TOWING ATTACHMENTS					
FIG. 237 TOWING PINTLE MOUNTING BRACKETS					
1	PAOZZ	19207	8330743	BRACE,PINTLE HOOK UOC:614,620,622,623,624,625,626,628,629,630,631,632,637,638	2
2	PFOZZ	19207	8331200	BRACKET,PINTLE UOC:614,620,622,623,624,625,626,628,629,630,631,632,637,638	1
3	PAOZZ	96906	MS21045-10	NUT,SELF-LOCKING,HE UOC:614,620,622,623,624,625,626,628,629,630,631,632,637,638	4
4	PAOZZ	96906	MS21045-12	NUT,SELF-LOCKING,HE UOC:614,620,622,623,624,625,626,628,629,630,631,632,637,638	8
5	PAOZZ	96906	MS21045-8	NUT,SELF-LOCKING,HE UOC:614,620,622,623,624,625,626,628,629,630,631,632,637,638	12
6	PAOZZ	96906	MS90727-114	SCREW,CAP,HEXAGON H UOC:614,620,622,623,624,625,626,628,629,630,631,632,637,638	4
7	PAOZZ	96906	MS90726-113	SCREW,CAP,HEXAGON H UOC:614,620,622,623,624,625,626,630,631,632,637,638	8
7	PAOZZ	96906	MS90726-115	SCREW,CAP,HEXAGON H UOC:628,629	8
8	PAOZZ	96906	MS90727-190	SCREW,CAP,HEXAGON H UOC:614,620,622,623,624,625,626,628,629,630,631,632,637,638	2
9	PAOZZ	96906	MS15001-1	FITTING,LUBRICATION UOC:614,620,622,623,624,625,626,628,629,630,631,632,637,638	1
10	PAOZZ	96906	MS90727-189	SCREW,CAP,HEXAGON H UOC:614,620,622,623,624,625,626,628,629,630,631,632,637,638	2
11	PAOZZ	19207	8330742	BRACKET,PINTLE HOOK UOC:614,620,622,623,624,625,626,628,629,630,631,632,637,638	1
12	PAOZZ	96906	MS90727-191	SCREW,CAP,HEXAGON H UOC:614,620,622,623,624,625,626,628,629,630,631,632,637,638	4
13	PAOZZ	96906	MS90727-163	SCREW,CAP,HEXAGON H UOC:614,620,622,623,624,625,626,628,629,630,631,632,637,638	4

END OF FIGURE